

V2 KEY INFORMATION



Overall Length	385mm
Hanging Length	360mm
Overall Width	230mm
Cover Width	200mm
Mass (approx.)	2.95kg

COLOURS
Grey
Brown
Red
Autumn

	PITCH	BATTEN SPACING	HEADLAP	TILES PER M ²	BATTEN PER M ²	MASS PER M ²	NAIL SIZE
V2	17.5°-70°	310mm max 285mm min	75mm min 100mm max	16.13/m ² 17.54/m ²	3.23lm 3.51lm	47.58kg 51.75kg	50mm x 3.35mm

VERGE SYSTEM

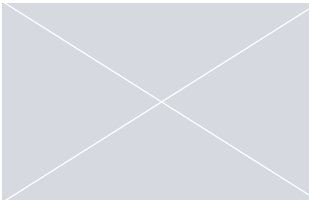

Mortar bedded only
Verge clips available

RIDGE SYSTEM



Coverage: 3m Pack
Use with: Half Round or Uni Angle Ridge (NH)
5000mm²/linear metre free vent area
Pitch limits: 17.5° - 55°

TILE CLIPS



Packs of 100
Tile clip nails into batten
Made from plastic

VENT TILES



Made from concrete
Air Vent - Vent Tile Only
Soil Vent - Vent Tile, 100mm flexi pipe
7860mm² Free Vent Area
Pitch Limits: 17.5° - 55°

HIP SYSTEM



Coverage: 6m Pack
Use with: Third Round or Uni Angle Hips (NH)
Not Ventilated
Pitch Limits: 17.5° - 55°

VERGE CLIPS

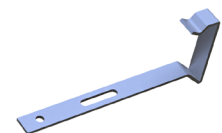

Packs of 50
Use with mortar bedded verge
Fits on verge tiles and nails to batten
Made from stainless steel

V2 PRODUCT CODES

TILES & FITTINGS	
Description	Product Code
V2 Tile	BUZ/7909/V201/--

ANCILLARY PRODUCTS	
Description	Product Code
V2 Vented Ridge Pk (3m)	BUZ/7951/V2T5/--
PAN8/V2/Cen/Sen Hip Pk (6m)	BUZ/7956/P8DH/00
V2 Air Vent Kit	BUZ/7955/V2IV/--
V2 Soil Vent Kit (inc.flexipipe)	BUZ/7955/V2IS/--
Eaves Vent Starter Pk (6m)	BUZ/7955/U5E5/00
Eaves Vent Starter Pk (6m)	BUZ/7955/U5E7/00
V2 Tile Clips (Pk 100)	BUZ/7951/V252/--
V2/Hardrow Verge Clips (Pk 50)	BUZ/7960/V253/00

SUITABLE RIDGE/HIP TILES	
Description	Product Code
Ridge Half Round (450mm)	BUZ/7935/0516/--
Ridge Half Round Nailhole (450mm)	BUZ/7935/D516/--
Ridge Half Round Block End (450mm)	BUZ/7940/D524/--
Ridge Universal Angle (450mm)	BUZ/7935/U516/--
Ridge Universal Angle Nailhole (450mm)	BUZ/7935/UD16/--
Ridge Uni Angle Block End (450mm)	BUZ/7940/U524/--
Ridge Half Round Mono (450mm)	BUZ/7940/0300/--
Ridge HR Mono Block End LH (450mm)	BUZ/7940/0324/--
Ridge HR Mono Block End RH (450mm)	BUZ/7940/0325/--
Ridge Scrolltop Half Round (450mm)	BUZ/7940/HR30/--
Ridge Scrolltop HR Block End (450mm)	BUZ/7940/HR29/--
Ridge Half Round Baby (300mm)	BUZ/7940/0020/--
Ridge Angle Baby (300mm)	BUZ/7940/0019/--
Hip Third Round (450mm)	BUZ/7935/0566/--
Hip Third Round Nailhole (450mm)	BUZ/7935/D566/--
Hip Third Round Block End (450mm)	BUZ/7940/D526/--
Hip Universal Angle (450mm)	BUZ/7935/U566/--
Hip Universal Angle Nailhole (450mm)	BUZ/7935/UD66/--
Hip Uni Angle Block End (450mm)	BUZ/7940/U526/--

PLAIN TILES (FOR VERTICAL TILING)	
Description	Product Code
Plain Tile	BUZ/7907/P501/--
Plain Tile & Half	BUZ/7945/P507/--
Plain Tile Eaves & Tops	BUZ/7945/P506/--
Beavertail Tile	BUZ/7930/BT01/--
Beavertail RH Tile & Half	BUZ/7945/BT08/--
Beavertail LH Tile & Half	BUZ/7945/BT07/--
Plain Tile Bonnet Hip	BUZ/7950/PT13/--
90 Deg LH Ext Angle	BUZ/7950/PT11/--
90 Deg RH Ext Angle	BUZ/7950/PT12/--
135 Deg LH Ext Angle	BUZ/7950/PT31/--
135 Deg RH Ext Angle	BUZ/7950/PT32/--